

OCEAN HOUSE

SURFSIDE

RESIDENCE 03 FLOOR 3-9
 4 BEDROOMS
 4 BATHROOMS
 POWDER ROOM
 INTERIOR: 2,633 SF
 EXTERIOR: 1,095 SF
 TOTAL: 3,728 SF

CITY & BAY VIEWS

ATLANTIC OCEAN

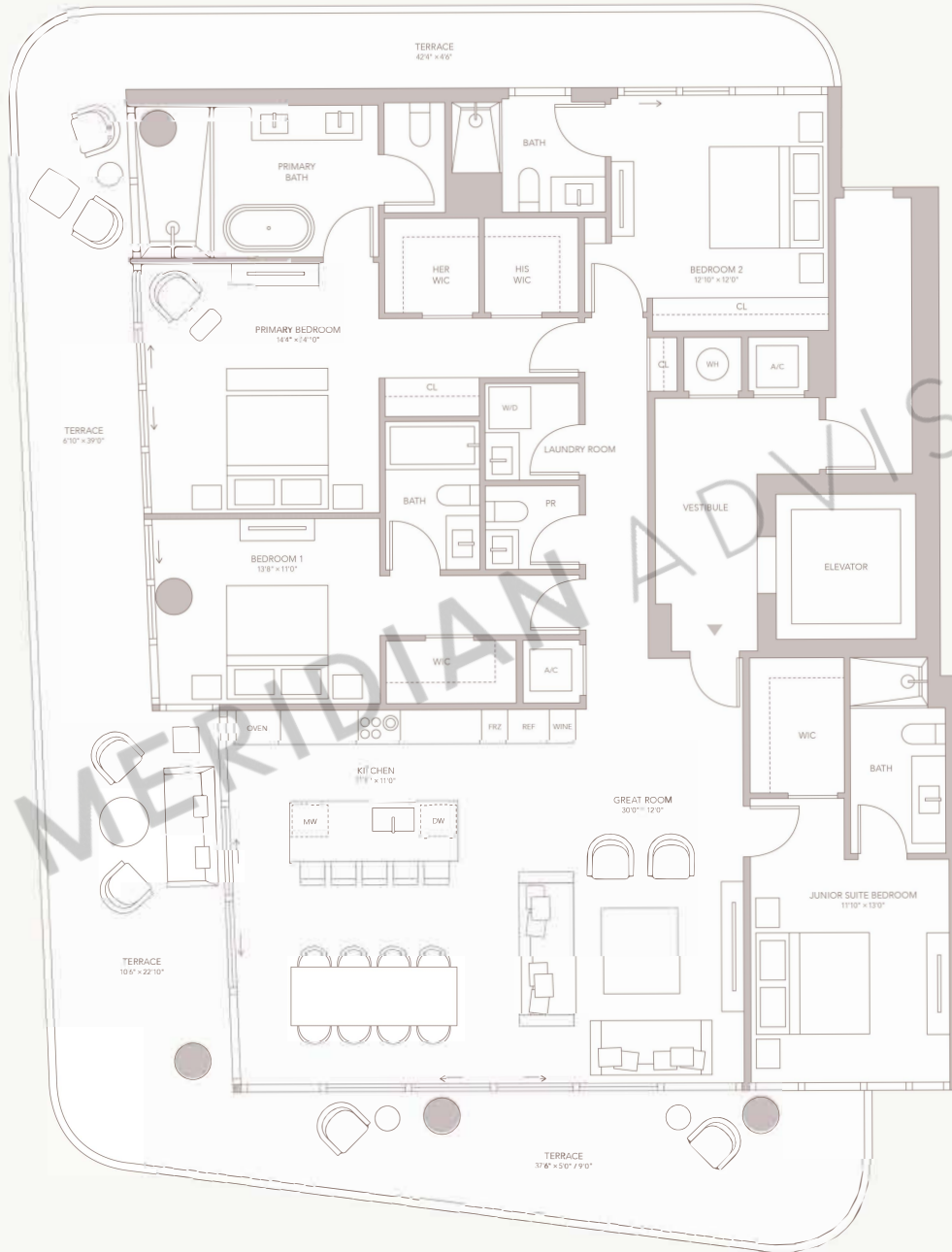

ORAL REPRESENTATIONS CANNOT BE RELIED UPON AS CORRECTLY STATING THE REPRESENTATIONS OF THE DEVELOPER. FOR CORRECT REPRESENTATIONS, PLEASE REFER TO THE BROCHURE AND TO THE DOCUMENTS REQUIRED BY SECTION 718.04, FLORIDA STATUTES, TO BE FURNISHED BY A DEVELOPER TO A BUYER OR LESSEE.

Stated square footages and dimensions are measured to the exterior boundaries of the exterior walls and the construction of exterior demising walls and in feet may vary from the square footage and dimensions that would be determined by using the description and definition of the "Gross" area forth in the Declaration which generally only includes the interior airspace between the exterior walls and excludes all interior structural components and other common elements. For your reference, the area of the unit, determined in accordance with these defined wall boundaries, is an "EACH UNIT" as the Declaration of Condominium contained in the Prospectus. Measurements of rooms set forth on this floor plan are generally taken at the finished grade of each given room. If the room walls are perforated, without regard for any alcove or variations. Accordingly, the area of the actual room will likely be another 10% the product obtained by multiplying the stated length and width. All dimensions are approximate and may vary with actual construction and all floor plans, specifications and other development plans are subject to change and will not necessarily accurately reflect the final plans and specifications for the Development. Specific details, walls, inclusions, party walls, baseboards, and any other major details will not be finished or furnished with accessories, fixtures, or hardware packages. These spaces are intended to be completed by the owner, including the final preferences after closing. While colors are not indicated by the Developer, the same color area indicated on the plan for the Residences and Penthouse is for reference purposes only. The necessary information will be provided for future installation by the owner. Any such installation or customization shall be the owner's responsibility after closing. All drawings of elevators, creature walls, baseboards, finishes and other matters of detail, solutions without limitation.